

Project:	
Type:	
Catalog #:	



STANDARD



The LEDHBRNS is a round LED high bay luminaire, which is designed to illuminate a wide variety of settings, including commercial, industrial & retail settings such as warehouses, manufacturing plants, sporting venues and big-box retailers. With a die cast aluminum housing and polycarbonate lens, the LEDHBRNS provides durability and high performance. High-efficacy, long-life LEDs provide both energy and maintenance cost savings compared to traditional, HID high bays.

FEATURES

- Available in 4000k (neutral white) and 5000k (cool white) color temperatures.*
- Long-life LEDs provide 80,000 hours of operation with at least 70% of initial lumen output (L_{70}).**
- LEDHBRNS100W provides 13,093 lumens (127 lumens per watt, LPW) at 4000k, and 13,116 lumens (127 LPW) 5000k.*
- LEDHBR150W provides 18,240 lumens (120 LPW) at 4000k, and 18,450 lumens (121 LPW) 5000k.*
- Universal 120-277 AC voltage (50-60Hz) is standard. Step-down transformers are required for 347-480V applications.
- 0-10vdc dimming drivers are standard.
- Watertight, compression-type electrical connectors prevent moisture intrusion.
- Standard mounting bracket and optional mounting accessories provide ceiling and conduit mounting, and up to 100° of adjustability.
- Optional wet-location junction box & bracket (LEDHBRNS-JBOX) attaches to luminaire housing, and simplifies wiring connections in wet locations.
- Optional Merrytek occupancy sensor (IP65 rated) and junction box assembly provides a factory-ready, fully-wired luminaire & control package.
- Power factor > 0.90.
- Total harmonic distortion < 20%.
- Color rendering index > 80.
- Painted die cast aluminum housing.
- Easy installation in new construction or retrofit.

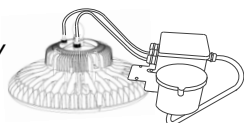

LEDHBRNS With Waterproof Junction Box, Mounting Bracket & Merrytek Sensor

* Contact factory for other color temperatures and lumen packages.
** L_{70} hours are IES TM-21-11 calculated hours.

WARRANTY & LISTINGS

- cULus listed for wet locations in ambient temperatures from -20°C to 50°C (-4°F to 122°F).
- IP65 rated for ingress protection.
- DLC standard approved.
- IK 7 rated for protection from external impacts.
- Complies with FCC Part 15, class B.
- Complies with EN61000-4-5, surge immunity protection (4kV).
- 5-year warranty of all electronics and housing.

MOUNTING OPTIONS

- Suspension from pre-installed mounting hook (cast iron M10 eyebolt) with locking set screw is standard.
- Ceiling-mounted installation (using optional yoke mounting bracket, LEDHBRNS-YOKE) provides up to 100° of adjustability.
- Two ways to mount luminaire to electrical conduit:
 - Attach conduit (½" NPS) to optional yoke mounting bracket (LEDHBRNS-YOKE).
 - Optional snap hook (LEDHBRNS-PSH) attaches to electrical conduit (¾" NPS).

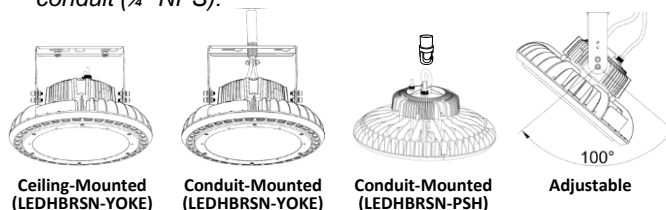

DIMENSIONS

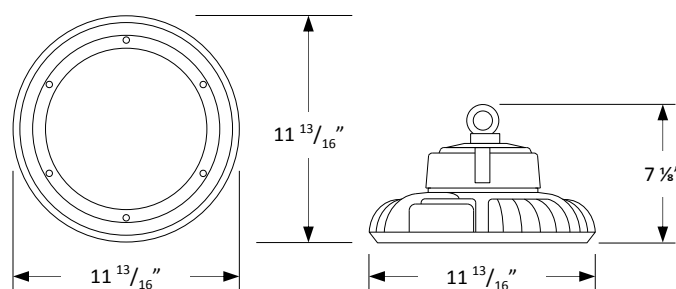

Weight: 8.4 lbs.

ORDERING INFORMATION

Example: LEDHBRNS100-4K + LEDHBRNS-PSH+ LEDHBRNS-OSJBOX

Model	Luminaire Watts	Luminaire Lumens	Lumens Per Watt	Color Temperature	Options (Order Separately)*
LEDHBRNS100	103	13,093 13,116	127 127	4K = 4000k 5K = 5000k	LEDHBRNS-PSH = Snap hook LEDHBRNS-YOKE = Yoke mount bracket LEDHBRNS-JBOX = Junction box & mounting bracket LEDHBRNS-OSJBOX = Merrytek IP65-Rated, microwave occupancy sensor, junction box & mounting bracket
LEDHBRNS150	152	18,240 18,450	120 121	4K = 4000k 5K = 5000k	

* Luminaire must be yoke mounted if installing the JBOX or OSJBOX.

ELECTRICAL DATA

Model	Color Temp.	CRI ¹	Luminaire Lumens	Luminaire Watts	Lumens/Watt	Input Voltage ²	Input Current (A)			Power Factor	THD ³	L ₇₀ Hours ⁴
							120V	240V	277V			
LEDHBR SN100-4K	4000k	>80	13,093	103	127	120-277	0.86	0.43	0.37	>90%	<20%	80,000
LEDHBR SN100-5K	5000k	>80	13,116	103	127	120-277	0.86	0.43	0.37	>90%	<20%	80,000
LEDHBR SN150-4K	4000k	>80	18,240	152	120	120-277	1.27	0.63	0.55	>90%	<20%	80,000
LEDHBR SN150-5K	5000k	>80	18,450	152	121	120-277	1.27	0.63	0.55	>90%	<20%	80,000

¹ Color rendering index.

² All 50-60Hz.

³ Total harmonic distortion.

⁴ L₇₀ refers to the number of hours at which lumen output declines to 70% of the initial level. L₇₀ hours are IES TM-21-11 calculated hours.

PHOTOMETRIC DATA

LEDHBR SN100-5K (13,116 Lumens)

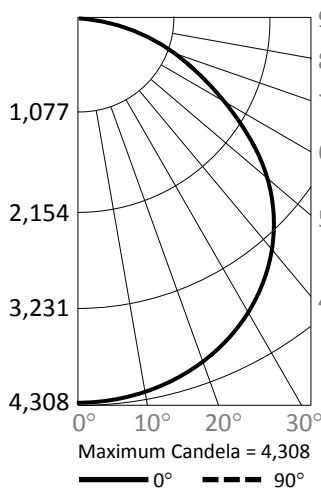

Candlepower Summary

	0°	90°
0°	4,308	4,308
10°	4,265	4,259
20°	4,089	4,073
30°	3,788	3,758
40°	3,345	3,305
50°	2,755	2,727
60°	1,918	1,878
70°	1,012	974
80°	220	199
90°	2	3

Zonal Lumen Summary

Zone	Lumens	% Fixture
0° – 10°	636	4.9%
0° – 20°	2,527	19.3%
0° – 30°	5,561	42.4%
0° – 40°	9,158	69.8%
0° – 50°	11,544	88.0%
0° – 60°	12,434	94.8%
0° – 70°	12,870	98.1%
0° – 80°	13,066	99.6%
0° – 90°	13,090	99.8%
90° – 180°	26	0.2%
0° – 180°	13,116	100.0%

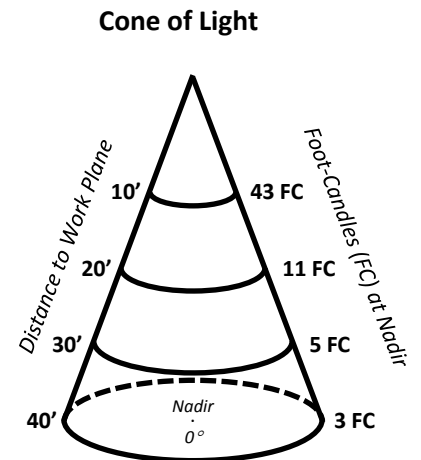

LEDHBR SN150-5K (18,450 Lumens)

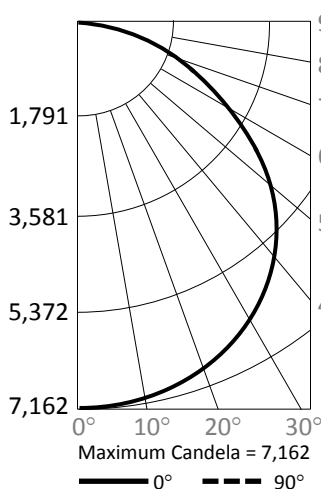

Candlepower Summary

	0°	90°
0°	7,162	7,162
10°	7,105	7,127
20°	6,837	6,839
30°	6,357	6,373
40°	5,626	5,623
50°	4,610	4,626
60°	3,223	3,233
70°	1,644	1,683
80°	273	332
90°	1	1

Zonal Lumen Summary

Zone	Lumens	% Fixture
0° – 10°	620	3.4%
0° – 20°	2,415	13.1%
0° – 30°	5,184	28.1%
0° – 40°	8,594	46.6%
0° – 50°	12,190	66.1%
0° – 60°	15,334	83.1%
0° – 70°	17,491	94.8%
0° – 80°	18,343	99.4%
0° – 90°	18,409	99.8%
90° – 180°	41	0.2%
0° – 180°	18,450	100.0%

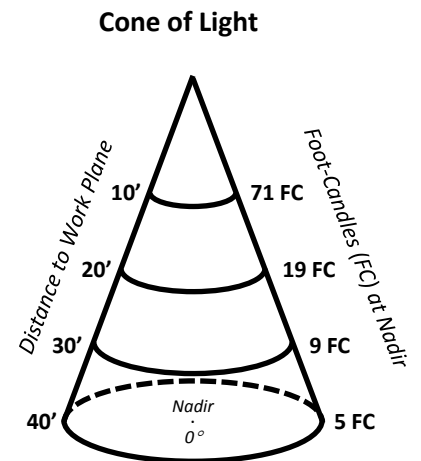

PHOTOMETRIC DATA

LEDHBRSN100W-5K (13,116 Lumens)

LEDHBRSN150W-5K (18,450 Lumens)

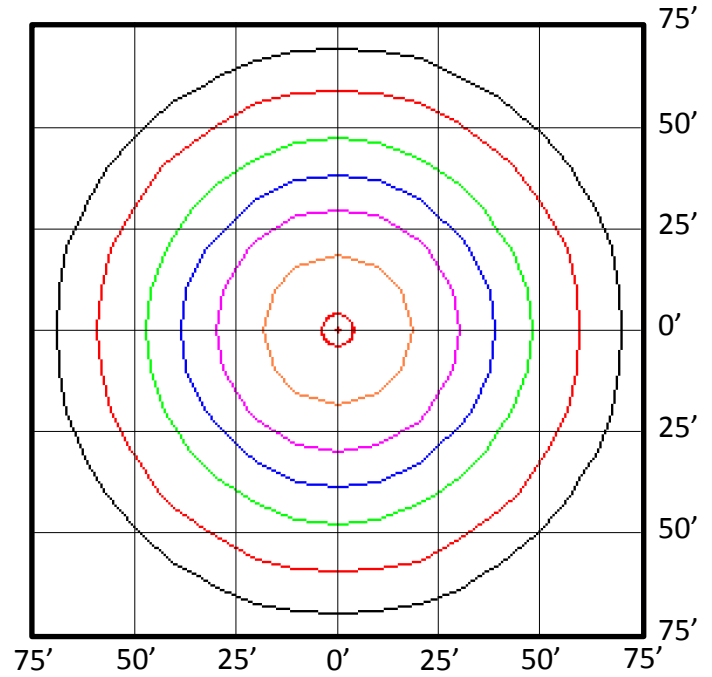
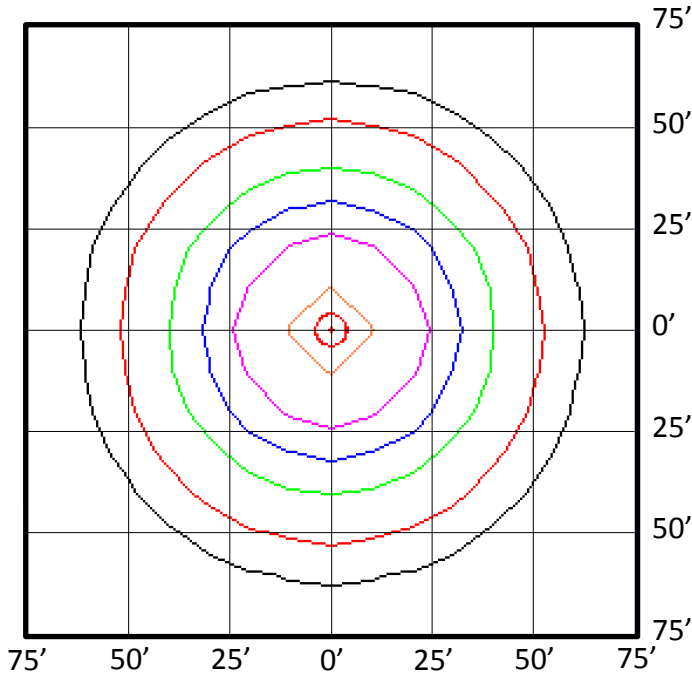

- Foot Candles**
- 5.0
 - 2.0
 - 1.0
 - 0.5
 - 0.2
 - 0.1

Notes:

- Isofootcandle plots depict initial footcandles at grade.
- Gridlines represent units of mounting height of 25 feet.